

TRAVEL  
INFO &  
FAQS

---

# S4SN

T S U K U B A J A P A N

M A R C H 2 5 - 2 8 , 2 0 2 4

---



@S4SNeuro  
[www.S4SN.org](http://www.S4SN.org)

# TABLE OF CONTENTS

Introduction.....	01
<b>1. Arriving in Japan</b>	
• Travel Visas.....	02
• Immigration & customs.....	03
• Travelling to Tsukuba.....	04
◦ Bus travel.....	05
◦ Bus and train travel.....	08
◦ Car travel.....	11
<b>2. Getting around in Japan</b>	
• Useful numbers and websites.....	12
• Payments.....	13
• Suica card.....	14
• Travelling.....	15
<b>3. Getting around in Tsukuba.....</b>	<b>16</b>
• Tsukuba station map.....	17
• Conference venue.....	18
• Directions.....	19
• Accommodations.....	23
• Restaurants.....	24
• Shopping.....	25
<b>4. Excursion recommendations.....</b>	<b>26</b>
• Tsukuba area.....	27
• Tokyo area.....	30
• More things to see.....	36

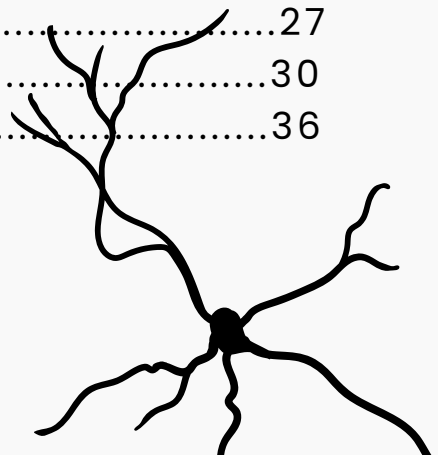

# INTRODUCTION

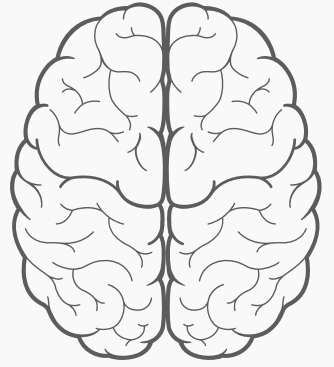

Welcome to the vibrant city of Tsukuba, Japan - a convergence of cutting-edge science, cultural richness, and natural beauty. As you embark on this conference journey, Tsukuba unfolds as a captivating destination, seamlessly blending modernity with tradition.

This city, with its world-class institutions and research facilities, provides the perfect backdrop for intellectual exchange and collaboration. Beyond the conference, discover the charm of Tsukuba's unique cultural heritage. As you explore the dynamic intersections of science, culture, and nature in Tsukuba, we invite you to immerse yourself in an unforgettable experience. This conference is not just an academic gathering but a journey into the heart of Japan's innovation and hospitality.

We welcome you to Tsukuba - where ideas flourish, connections thrive, and memories are forged.



Scan this QR code for access to our travel guide website, featuring maps, attractions, excursions, and more!

# INTERNATIONAL TRAVEL INFORMATION

## TRAVEL VISAS

*As part of your travel preparations, we would like to remind you that certain international visitors may require a visa to enter Japan.*

*To facilitate a smooth and timely visa application process, we recommend reviewing the guidelines and requirements provided by the Japanese government, which can be found at the following links:*

1. [https://www.mofa.go.jp/j\\_info/visit/visa/index.html](https://www.mofa.go.jp/j_info/visit/visa/index.html)
2. [https://www.mofa.go.jp/j\\_info/visit/visa/short/other\\_visa.html](https://www.mofa.go.jp/j_info/visit/visa/short/other_visa.html)

***Please note that visa procedures vary based on nationality and your current country of residence. Therefore, it is crucial to carefully examine the information in the links above to understand the specific requirements applicable to you.***

*Should you have any questions regarding the visa application process or if you need assistance from the Society for Social Neuroscience, do not hesitate to reach out to us. We are here to help ensure your journey to Tsukuba is as smooth as possible.*

# INTERNATIONAL TRAVEL INFORMATION

## IMMIGRATION & CUSTOMS

*After arriving at the airport (Narita or Haneda), you will need to go through the usual immigrations and customs.*

*For customs, you can either fill out the customs form on a physical piece of paper or online. Only one customs form is required per family.*

### **If you choose to use a physical form :**

1. A physical copy of the form usually gets distributed during the flight, or there are also some available in the baggage claim area.
2. You will need to go through the in-person customs area.

### **If you choose to use an online form:**

1. Go to the **Visit Japan website** to fill it out. You will be given a QR code once you have filled out the customs form.
2. Once in the baggage claim area, find a customs QR code reader machine. You will need your QR code and your passport.
3. Go through the customs e-gates. Gates should open just with facial recognition.

# TRAVELLING TO TSUKUBA

***We strongly recommend using either Airport buses or taxis, but not train routes from Narita Airport. From Haneda Airport, Tsukuba Station can be accessed by train routes but three different train rides are necessary.***

As you will see in the next few pages, there are multiple ways to travel to Tsukuba from Narita and Haneda Airports. The local committee recommend that you travel by bus, which is the most direct way of travel.

Wherever you will be travelling from, you will arrive a Tsukuba Center/Tsukuba TX Station. From there, Hotel Nikko Tsukuba and Daiwa Roynet Hotel are a 2-minute walk from the bus stop at the Tsukuba Center. Hotel JAL City is about a 5-7 minute walk.

For those travelling from Haneda Airport

**\*\*\* The ticket booth at Haneda Airport may be closed for late-arrival flights. \*\*\***

Tickets may need to be purchased from a ticket machine around the bus gate with cash (not sure credit card is accepted).

Airport buses are also available to many Tsukuba Express (TX) stations, including those not mentioned in the following pages (e.g., Akihabara Station).

- But other stations tend to be bigger and need to walk longer to get to the TX entrance. Transferring to the TX at Kashiwanoha Campus Station is the easiest and smoothest.
- There are also many bus services to Kita-Senju Station, but this station is also quite big and it can be complicated to transfer to the TX.

For those travelling on Tsukuba Express (TX) trains

**\*\*\* Be aware that car 1 for trains bound for Tsukuba after 18:00 on weekdays is for women only. \*\*\***

# TRAVEL BY BUS

## BETWEEN NARITA AIRPORT AND TSUKUBA

### *OPTION A: Narita Airport to Tsukuba Center by Airport Bus Service*

1. You will be arriving in Terminals 1, 2 or 3, depending on the airline.
2. After you finish the customs, please go to the Keisei bus booth (not the Limousine bus booth) to get a bus ticket to Tsukuba Center.
3. A bus ticket will cost JPY 2,400 and can be paid with a credit card.
4. The bus gate is right outside of the terminal building. Please check the gate number at the ticket booth.
5. It will take about 55-65 minutes to get to the Tsukuba Center. This bus service ends at Tsuchiura JR Station. So please be careful not to miss the Tsukuba Center stop.
6. A quick walk to the hotel of your choice.

**\*\*\* You need to reserve the return leg from Tsukuba Center to Narita Airport \*\*\***

Please purchase a ticket at the bus ticket office at the Tsukuba Center near gate 8, where the airport buses depart. If you need help, please come to the Help Desk run by the S4SN2024 local committee during the meeting.

For the bus timetable and more information, please click [here](#).



# TRAVEL BY BUS

## BETWEEN HANEDA AIRPORT AND TSUKUBA

### *OPTION B: Haneda Airport to Tsukuba Center by Airport Bus Service*

1. You will be arriving at Terminal 3 for international flights.
2. After you finish the customs, please go to the Limousine bus counter to get a bus ticket to Tsukuba Center.
3. A bus ticket will cost JPY 2,000 and can be paid with a credit card.
4. The bus gate should be 9 (but please confirm at the booth). You need to go to the first floor of the airport building and walk to the gate after you exit the door.
5. It takes about 2 hours to get to Tsukuba Center, which is the last stop on the bus line.
6. A quick walk to the hotel of your choice.

**\*\*\* There are only two services per day and the last bus to Tsukuba Center leaves at 17:05 from Haneda Airport. \*\*\***

Please see on the following pages for alternative bus/train routes via Kashiwanoha-Campus Station and via Kitasenju Station.



# TRAVEL BY BUS

## HANEDA BUS TIMETABLE

Terminal 3	Terminal 2	Terminal 1	Local Stops in Tsukuba					Tsukuba Center
9:20	9:30	9:35	11:13	11:15	11:16	11:17	11:18	11:20
17:05	17:15	17:20	18:58	19:00	19:01	19:02	19:03	19:05

Tsukuba Center	Local Stops in Tsukuba					Terminal 2	Terminal 1	Terminal 3
6:00	6:02	6:03	6:04	6:05	6:07	7:47	7:52	7:59
13:10	13:12	13:13	13:14	13:15	13:17	14:47	14:52	14:59

**\*\*\* No reservation is necessary for the return trip to Haneda Airport from Tsukuba Center. \*\*\***

Please purchase a ticket at the bus ticket office at Tsukuba Center near gate 8, where the airport buses depart. You can also pay directly to the driver by cash or by a Suica card (see [page 13](#) for Suica cards). If you need help, please come to the Help Desk run by the S4SN2024 local committee during the meeting.

**Bus tickets can be purchased at the airport with a credit card.** For late-night flights, ticket booth at Haneda Airport may be closed. Tickets to Kashiwano-Ha Campus Station from Haneda (JPY 1,600) may need to be purchased from a ticket machine with cash (not sure credit card is accepted).

# TRAVEL BY BUS & TX TRAIN

## **BETWEEN HANEDA AND TSUKUBA**

*OPTION C: Haneda Airport to Tsukuba Center via  
Kashiwanoha-Campus Station*

1. You will be arriving at Terminal 3 for international flights.
2. After you finish the customs, please go to the Limousine bus counter to get a bus ticket to Kashiwanoha-Campus.
3. A bus ticket will cost JPY 1,600 and can be paid with a credit card.
4. The bus gate should be 6 (but please confirm at the booth). You need to go to the first floor of the airport building and walk to the gate after you exit the door.
5. It takes about 100 minutes to reach the Kashiwanoha-Campus stop – which is at the Tsukuba Express (TX) train station. This bus service ends at Kashiwa Station. So please be careful not to miss Kashiwanoha-Campus stop.
6. Take the TX (semi-rapid or local) train bound for Tsukuba (not Moriya). It costs JPY 690. The last train from this station to Tsukuba leaves at 00:19.
7. It takes about 20-30 minutes to get to TX Tsukuba Station.
8. A quick walk to the hotel of your choice.

For a timetable and more information on travel from Haneda Airport to Kashiwanoha Campus, please click [here](#).

For a timetable and more information on travel from Kashiwanoha Campus TX Station to Tsukuba TX Station, please click [here](#).

# TRAVEL BY BUS & TX TRAIN

## BETWEEN HANEDA AND TSUKUBA

*OPTION D: Haneda Airport to Tsukuba Center via Kita-Senju Station*

1. You will be arriving at Terminal 3 for international flights.
2. After you finish the customs, please go to the Limousine bus counter to get a bus ticket to Kita-Senju Station run by Keikyu Bus Service.
3. A bus ticket will cost JPY 1,100 and can be paid with a credit card.
4. The bus gate should be 4 (but please confirm at the booth). You need to go to the first floor of the airport building and walk to the gate after you exit the door.
5. Once you arrive at Kita-Senju Station Bus Terminal, go to Tsukuba Express (TX) entrance.
6. Take the TX (rapid or semi-rapid) train bound for Tsukuba (not Moriya). It costs JPY 1,050. The last train from this station to Tsukuba leaves at 23:56.
7. It takes about 35-45 minutes to get to TX Tsukuba Station.
8. A quick walk to the hotel of your choice.

For a timetable and more information on travel from Haneda Airport to Kita-Senju Station, please click [here](#).

For a timetable and more information on travel from Kita-Senju TX Station to Tsukuba TX Station, please click [here](#).

# TRAVEL BY BUS & TX TRAIN

## ROUTES FROM AIRPORTS

From TX Tsukuba Station (underground) and Tsukuba Center Bus Terminal (ground level )  
-2min walk to the Hotel Nikko Tsukuba (#1 in the Hotel List) and the Daiwa Roynet Hotel (#2)  
-5-7min walk to the Hotel JAL City (\*, Taxis are available at the Tsukuba Center Bus Terminal)

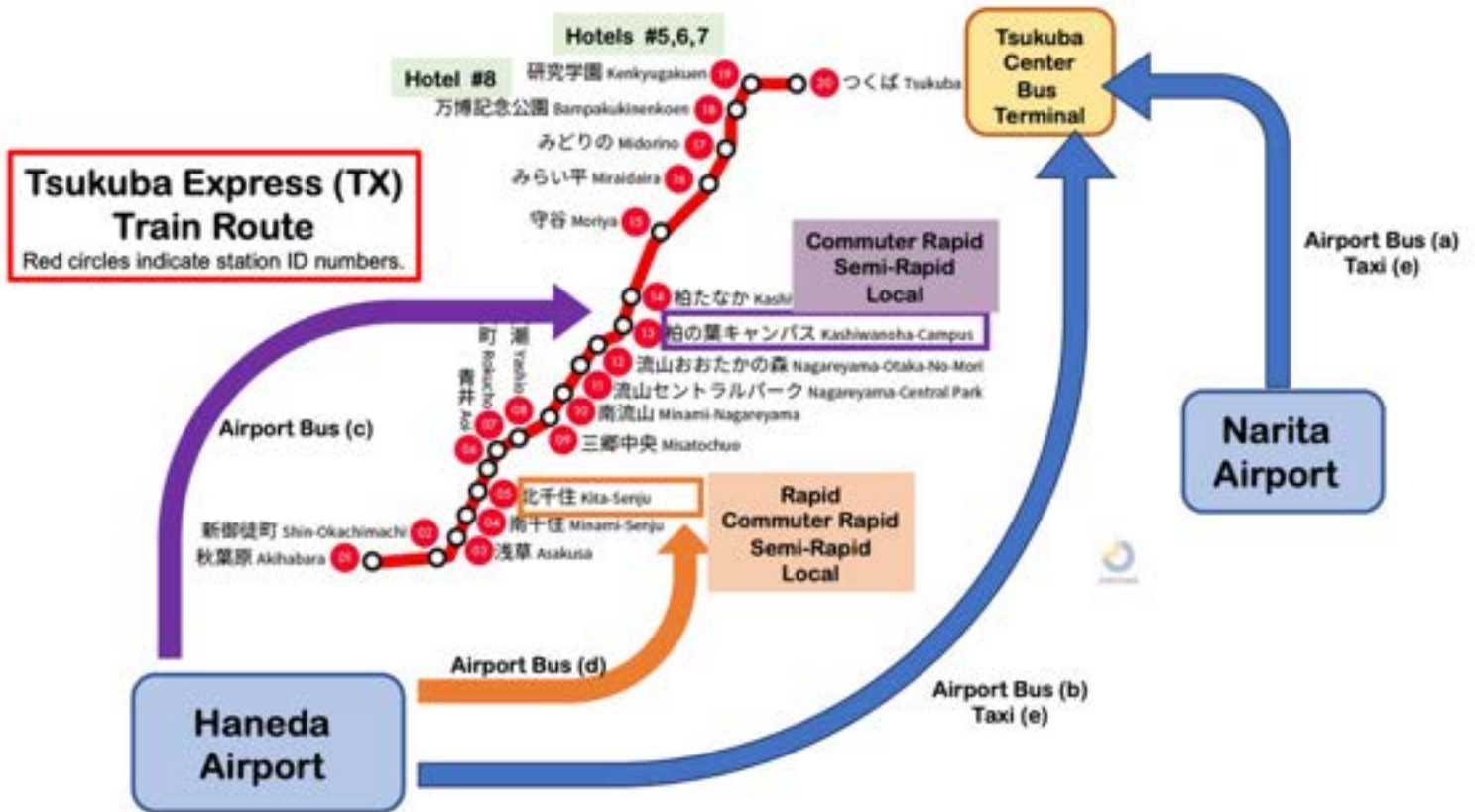

# TRAVEL BY CAR

## TAXI

### OPTION E: Taxi Services from Narita & Haneda Airport to Tsukuba City

1. **YoTaxis service** from Narita and Haneda Airport to Tsukuba.
  - Airport Transfers Private Van Taxi uses limousine type vans.
  - Transfers available from Narita/Haneda Airport and 23 wards of Tokyo to nationwide with low price.
  - Pick-up and drop-off at a flat rate. It can board 1 to 9 people.
  - For more information, click [here](#).
2. **Tsuchiura Taxi**
  - Based in Tsuchiura City, a neighboring city of Tsukuba.
  - Can be called by the GO-App-Service.
  - For more information, click [here](#).

## RENTAL CAR

### **Nippon Rent-A-Car**

- 3-5min walk from the Congress Center, Hotels around Tsukuba Center.

## PARKING

### **The venue**

- 1 day ticket JPY 1,070
- Maximum capacity: 27 for the north wing, and 51 for the south wing

### **Hotel JAL City**

- JPY 1,000/day (15:00-10:00 next day)
- Maximum capacity: 29

### **Hotel Nikko Tsukuba**

- JPY 1,000/day (16:00-11:00 next day)
- Maximum capacity: 79

### **Daiwa Roynet Hotel**

- JPY 1,000/day (15:00-10:00 next day)
- Maximum capacity: 60 at a nearby parking building

There are also a few parking buildings around Tsukuba Center.

# GETTING AROUND IN JAPAN

## USEFUL NUMBERS AND WEBSITES

### For emergencies

- Emergency: 110
- Tokyo Metropolitan Police English helpline
  - Phone: 03-3501-0110 (available 24/7).
- If you are feeling unwell, click [here](#) for more information.
- For weather warnings, including earthquakes, you can download [Safety tips app](#).
  - In case of an earthquake, see [here](#) on what to do.
  - In case of a tsunami warning, see [here](#) on what to do.
- For more, take a look at Japan safe travel information website.

### Tourist information center

- The Japan National Tourism Organization (JNTO) has a tourist information center in Tokyo.
  - Phone: 03-3201-3331, 09:00-17:00
  - You can also follow them [@JapanSafeTravel](#) on X.

### Some useful phrases

You can find some useful Japanese phrases to use from [here](#).

# PAYMENTS

***We strongly recommend that overseas participants exchange some cash to JPY prior to travel, or at Haneda/Narita Airport. Carrying cash is essential in Japan.***

## CASH OR CREDIT CARD?

Japan uses cash more than credit cards in commercial settings. Make sure that you have some Japanese Yen on you! And if in doubt, use Suica. You can find more about Suica on the [next page](#).

- Most train ticket machines (except Shinkansen, bullet trains) and bus fare boxes do NOT accept credit cards. Please prepare cash or a Suica card.

## CURRENCY EXCHANGE

There is only one shop (in a shopping mall across the street from the venue) that offers currency exchange. No banks in Tsukuba, including Post Offices, offer currency exchange services. There are limited services in central Tokyo. We strongly recommend that you exchange foreign currency to Japanese Yen at airports.

### Currency exchange shop in Tsukuba

Daikoku-ya Tsukuba at Dayz Town (1st floor of the Dayz Town shopping mall)

- Address: 1-9-2 Takezono, Tsukuba
- Phone: 029-886-9310
- Opening hours: 10:00-19:00
- Exchangeable Currencies (to JPY): US\$, Euros, UK£, CA\$, AU\$, KRWon, HK\$, THBaht, SG\$, PHPeso, CHYuan

## ATMs

You can withdraw cash from ATMs, but services are limited. You can find more about how to withdraw cash from ATMs in Japan from [here](#).



# SUICA CARD

Suica card is a must-have when travelling in Japan. Japan still has many shops that do not accept credit cards, but Suica cards are often accepted, along with cash.

***We strongly recommend that oversea participants purchase a “Welcome Suica Card” at Haneda, Welcome Suica exclusive vending machine. This is not available at Narita.***



## **Where to buy a Suica card?**

You can only purchase Suica cards from JR East Travel Service Center, which is located in a limited number of JR train stations and NOT in Tsukuba. *You can purchase in Apple Wallet, but NOT with a US Visa (only Mastercard or Amex)*

## **How to use a Suica card?**

This card can be used to pay fares for the following transport.

- TX train (Tsukuba to Tokyo area), subways and JR trains in Tokyo area, local busses in Tsukuba and Tokyo, airport bus fare (between Tsukuba and Haneda).
- Most taxi fares (taxis can usually be paid by credit card).
- Also, many stores, especially around train stations, accept this card for payment of merchandise.

## **Reloading**

Cards can be charged at ticket machines at all train stations (may take a credit card), or at the pay machine on the buses (mainly cash only, and you have to ask the driver in Japanese!)

## **Apple Wallet**

You will not be able to add Suica card to your Apple Wallet if you have a US Visa card, but it is compatible with MasterCard and AMEX.

# TRAVELLING

## WIFI ACCESS

Japan is usually not included in non-Asian phone plans. One solution to this problem is to rent a pocket WiFi. You can pick them up at the airport and also return them there. [Ninja wifi](#) is just one example of a company providing such a service.

## TRAINS

Trains are a very efficient way of travel. They are always on time, and run frequently. You can travel almost any trains with a Suica card (excluding the bullet train).

Tsukuba Express (TX) train is a convenient way of travelling from Tsukuba to central Tokyo. Please note that TX train will run on a new schedule starting on March 16, 2024. Please visit [here](#) before heading to Tsukuba.

You can travel around Tokyo by using a combination of the metro and JR lines. There are lots of metro and JR lines, and the network is quite complex! It is useful to use [Google Maps](#) or [Citymapper](#) to plan your trips.



# TSUKUBA

Tsukuba is a science city full of things to do. For practical day-to-day suggestions, please check the [website](#). These include:

- Nearby restaurants for lunch, as well as supermarkets and convenience stores to get food and drinks for lunch.
- Local attraction sites for family members.
- Restaurants for dinner, including those accessed by taxi or bus. We will also set up a sign-up sheet at the Help Desk for group dinners and help make reservations.
- Shopping malls in the Tsukuba area and popular shops for local and Japanese goods.



# TSUKUBA STATION AND SURROUNDING AREA

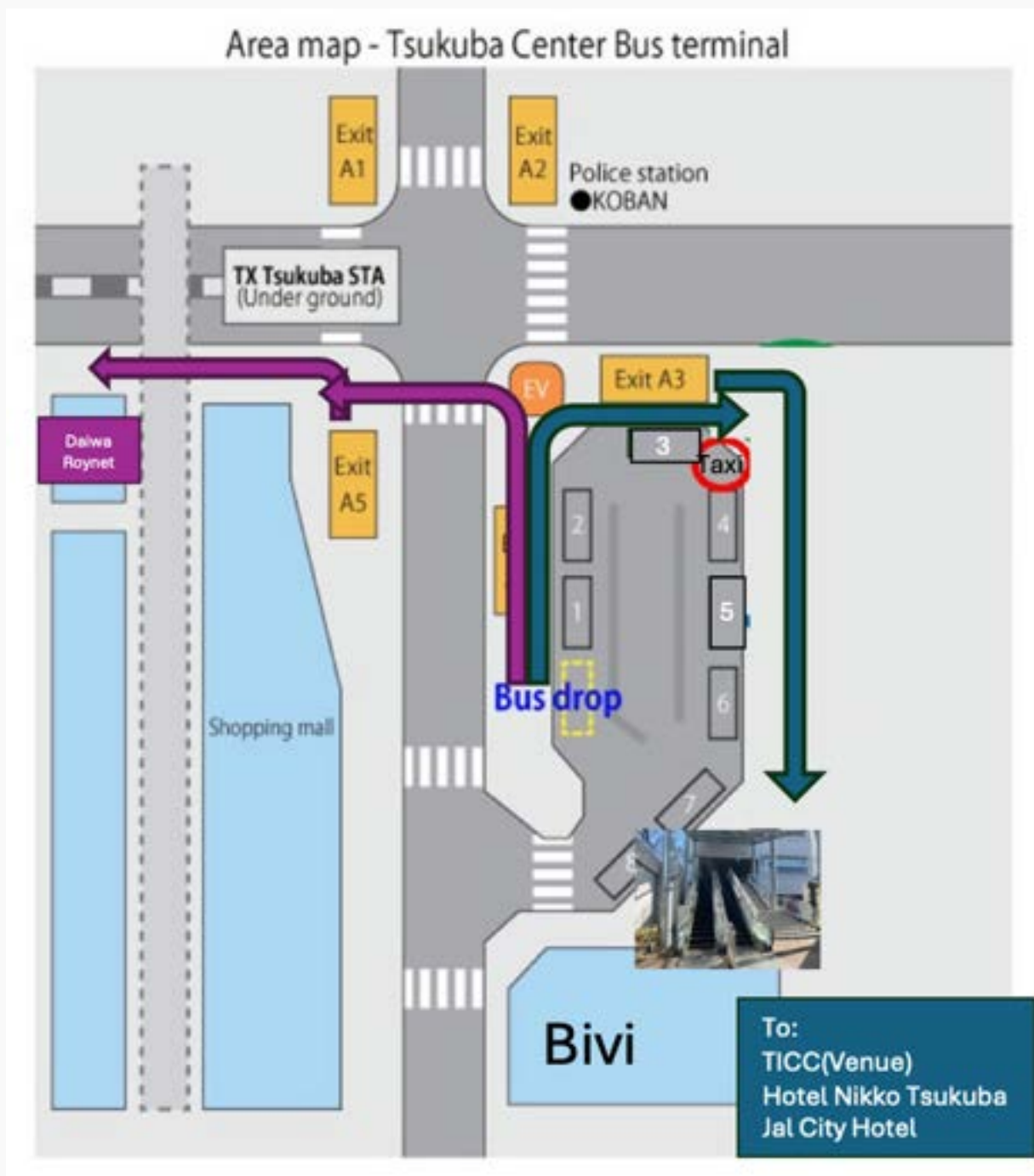



# TSUKUBA INTERNATIONAL CONGRESS CENTER

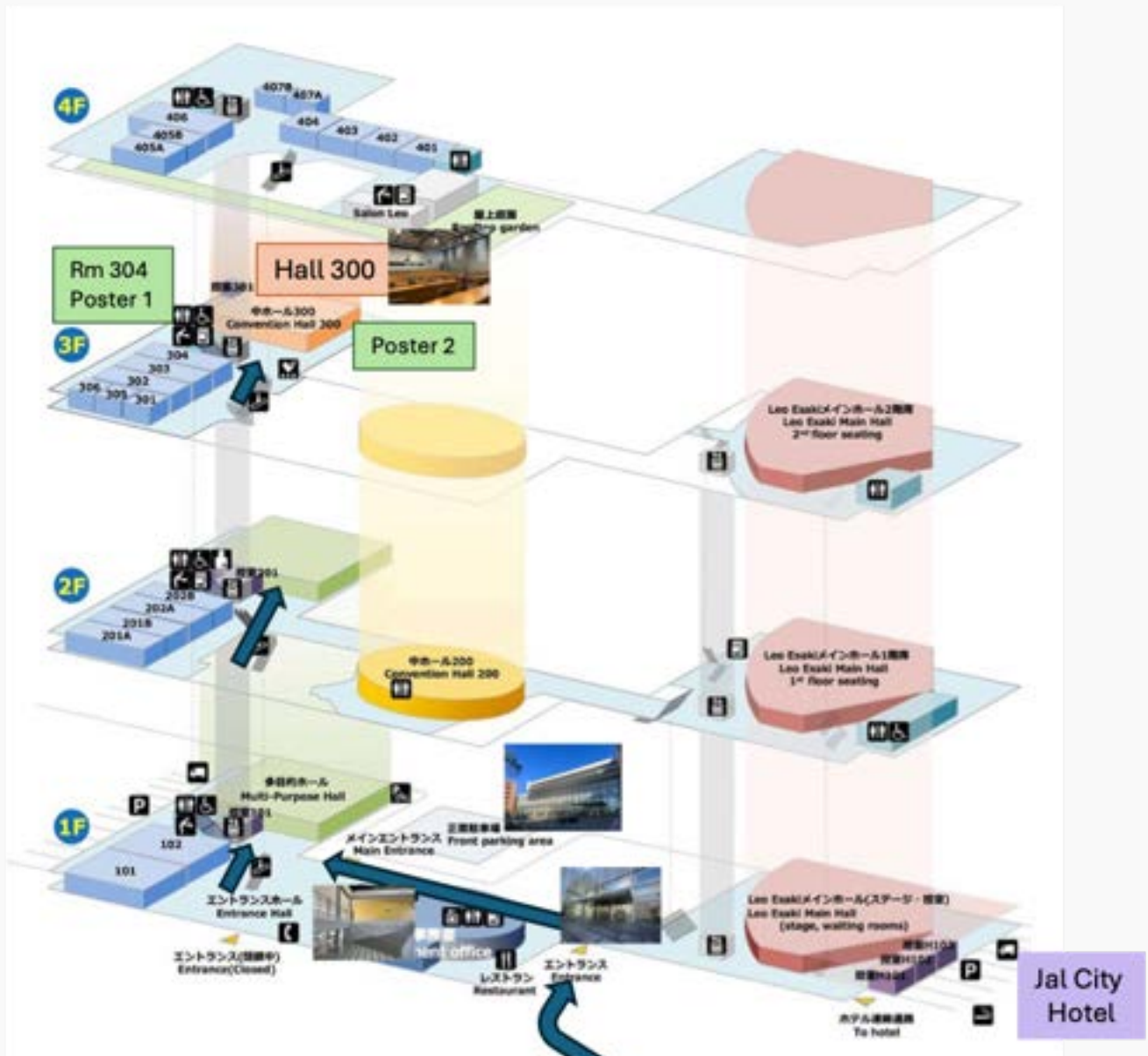

From  
TX Tsukuba Station  
Tsukuba Center Bus Terminal

# CONFERENCE VENUE

## FROM TX TSUKUBA STATION/TSUKUBA CENTER BUS STATION

Detailed access information to the conference venue, Tsukuba International Congress Center (TICC) can be found in [Japanese](#) and [English](#).



1. From the TX Tsukuba Station, take the escalator up and exit from exit A3 to go to the Bus Terminal at ground level.



2. Once you are at the Bus Terminal, walk towards the Bivi building to find an escalator next to the big stairs.



3. Take the escalator up to the second floor pedestrian path, and walk straight ahead (go south).



4. Cross the overpass.



5. Walk straight until you find a crossing, and cross this street to enter a park.



6. You will find a back door entrance to the Jal City Hotel on your right, but keep walking straight ahead until you find a back door entrance to the venue.



7. Once you are in the building, keep walking straight until you find the huge stairs.



8. Take escalators up to the third floor. You will find the Registration Desk right outside of Meeting Hall 300.

# HOTEL NIKKO TSUKUBA

## FROM TX TSUKUBA STATION/TSUKUBA CENTER BUS STATION



1. From the TX Tsukuba Station, take the escalator up and exit from exit A3 to go to the Bus Terminal at ground level.



2. Once you are at the Bus Terminal, walk towards the Bivi building to find an escalator next to the big stairs.



3. Take the escalator up to the second floor pedestrian path.



4. Turn left towards the hotel.



5. Enter this door.



6. Take an elevator down to the first floor to get to the reception desk of the hotel.



# DAIWA ROYNET HOTEL

## FROM TX TSUKUBA STATION/TSUKUBA CENTER BUS STATION



1. From the TX Tsukuba Station, take the escalator up and exit from exit A5.



2. Looking at the stairs on your left, enter the shopping mall building and take another escalators up.



3. Once at the ground level, turn left to go out of the building.



4. With Mister Donuts shop on your right, turn left on the sidewalk at this corner. If you arrive by bus, cross the road toward the Mister Donuts shop and follow steps 5 and 6 below.



5. Walk straight on the sidewalk (go west) for about 50 meters.



6. The hotel entrance will be on your left.

# JAL CITY HOTEL

## FROM TX TSUKUBA STATION/TSUKUBA CENTER BUS STATION



1. From the TX Tsukuba Station, take the escalator up and exit from exit A3 to go to the Bus Terminal at ground level.



2. Once you are at the Bus Terminal, walk towards the Bivi building to find an escalator next to the big stairs.



3. Take the escalator up to the second floor pedestrian path, and walk straight ahead (go south).



4. Cross the overpass.



5. Walk straight until you find a crossing.



6. Cross the street, turn right, walk along the street a few meters to find the main entrance (and parking lot) of the hotel.

or



6. Walk straight for a few meters after you cross the street to find a back door entrance (open until 23:00) to the hotel on your right

# ACCOMMODATIONS

	Map #	Location	Single	Double/Twin per room	BF Price	Website
Hotel Nikko Tsukuba	1	Tsukuba Center	-10,800	-18,000	Available	<a href="https://www.nikko-tsukuba.com/eng/">https://www.nikko-tsukuba.com/eng/</a>
Daiwa Roynet	1	Tsukuba Center	-11,000	-16,800	Available 1,400?	<a href="https://www.daiwaroynet.jp/en/tsukuba">https://www.daiwaroynet.jp/en/tsukuba</a>
Hotel Jal City (NEW!!)		Tsukuba International Congress Center	-10,000	-18,000	Available 1,600?	<a href="https://www.tsukuba.hoteljalcity.com/eng/">https://www.tsukuba.hoteljalcity.com/eng/</a>
Grand Shinonome	3	8 min walk to Tsukuba Center	-10,400	-19,000	Available (1,540?)	<a href="https://www.hg-shinonome.co.jp/english/">https://www.hg-shinonome.co.jp/english/</a>
Daily Inn	4	14 min walk to Convention Center (Away from the Tsukuba Center)	-4,800	Not Available	Not Available	(No direct english website, use hotel booking site)
Hotel Bestland	5	Near Train Station (Kenyu-gakuen) 1 Stop away from Tsukuba (2 min Train Ride)	-9,300	-12,000	Available (1,200?)	<a href="https://www.hotel-bestland.co.jp">https://www.hotel-bestland.co.jp</a>
Mark One Hotel	6	Near Train Station (Kenyu-gakuen) 1 Stop away from Tsukuba (2 min Train Ride)	-6,000	-11,000	Available (1,500?)	<a href="https://mark-1.jp/tsukuba/">https://mark-1.jp/tsukuba/</a>
Toyoko In	7	Near Train Station (Kenyu-gakuen) 1 Stop away from Tsukuba (2 min Train Ride)	-8,000	-10,000	Available	<a href="https://www.toyoko-inn.com/eng/index">https://www.toyoko-inn.com/eng/index</a>
Apa Hotel	8	Near Train Station (Banpaku-kinen-koen) 2 Stops away from Tsukuba (4 min Train Ride)	-6,000	-7,500	Available (900?)	<a href="https://www.apahotel.com/hotel/syutoken/ibarak/tsukuba-banpaku-kinen-koen-ekimae/">https://www.apahotel.com/hotel/syutoken/ibarak/tsukuba-banpaku-kinen-koen-ekimae/</a>
University of Tsukuba Guest House	9	5 min walk to Tsukuba Center (north of Tsukuba Center)	4,700	Not Available	Not Available	Reservation starts Feb 24, 2024 Max 22 rooms: Please contact Dr. Ogawa

There are also a number of "Onsen" (hot spring) at Tsukuba Mountain Area (may provide bus service to the Tsukuba Center, about a 40 minute bus ride)

Mount Tsukuba Edoya Inn

<https://visit.ibarakiguide.jp/en/accommodation/23798/>

Tsukuba Onsen Hotel

<https://www.tsukuba-onsen.co.jp>

Tsukubasan Keisei Hotel

<https://tsukubasan-keiseihotel.co.jp>

Tsukubasan Aokiya Hotel

<https://aokiya-hotel.com>

-Tsukuba Center: Tsukuba Express Train Station (bound Akihabara Station in Tokyo) and Bus Terminal (for Haneda and Narita Airport Bus)

-Convention Center is about a 5 minute walk from the Tsukuba Center

-We recommend reserving directly at the hotel site or using a reliable Japanese site.



# RESTAURANTS

## Restaurants Around Tsukuba Station

Information updated August 8, 2022. Please note there may be changes.

**QT**

- Japanese UDONYA
- Chinese TOGEN
- Korean NENE CHIKEN & JONGNO HATOGU
- Tokuyaki Tsukiji GINDACO
- Cafe Very Very CAFE
- Fast Food MOS BURGER
- Champion Noodle Ringer Hut
- Japanese Zangi Tei
- NEW YORK STEAK HOUSE

**QT Dining**

- Italian Seizeriya
- Soba Aoyama Garari
- barbecue TORAJI
- Indian SAINO
- Japanese/pub RASHIKU
- Ramen SEIROCK-YA

**Basement Level**

- STARBUCKS COFFEE
- Ibaraki JIZAKE BAR

**MOG**

- Chinese ROGAIRO (caf)
- Japanese/pub Tsukadanojota (caf)
- Wine & Beer Miura-Insyokudo

**CREO**

- Bakery BURUNO
- Pizza Hut
- BURGER KING
- Korean shop Isoilso
- Fish shop SANTO
- Daily Dish K's dining
- Food Market WAKU-WAKU HIROBA
- Chinese PEKINROU HANTEN

**Basement Level**

- Japanese/pub Bonito (caf)
- Italian Giji osteria (caf)

**DAYZ TOWN**

- Japanese/pub Uotami
- Membership club Zen
- Japanese/pub Kisal Kagari
- Pub/bar CARIBBEAN CAFE
- Chinese Monster
- Japanese/pub Kyutarou
- Japanese/pub HANA-BI
- Japanese/pub/Steak Techan
- Pub Craft Beer Bar
- Japanese/original Nakayama
- Japanese/pub Mott's Bar TAKANOYA
- Panicle Tsukuba Pancake 88 cafe
- Japanese/pub/Ramen Appare
- Japanese/pub APOLLO
- Japanese/pub Hitachinokuni MONDOKORO
- MUSIC & CAFE BAR WOODSTOCK
- Spanish Poco Loco

**Basement Level**

- Japanese/pub Hasuya Gonzaemon
- Chinese ROGAIRO (caf)
- Japanese/pub Tsukadanojota (caf)
- Wine & Beer Miura-Insyokudo

**Basement Level**

- soba Sobamonogatari Ichinaru (caf)
- Japanese/pub Hokkaido UOSEN SUISAN (caf)
- yakitori/bar Ushiwakamaru (caf)
- Kushikabu DENGANA (caf)
- Japanese ROKU (caf)
- Japanese OOTOYA (caf)
- Chinese ROGAIRO Bekkan (caf)
- Udon/Yakitori ASOUGI (caf)

**Basement Level**

- Hotel Nikko Tsukuba (Formerly known as Otsuka Frontier Hotel Tsukuba)
- Chinese Toh-Lee (ANNEX #1)
- Japanese Tsukuba Sansuitei Bettei (caf)
- Restaurant SERENA (caf)

**Basement Level**

- Beer&Cafe Engi
- York Town
- Cafe N's cafe
- SYU
- Ramen/Menya AOI
- Japanese/bar Rusien
- Bar Toyochu
- garlic Monster
- Indian Curry Himalaya
- Sushi Takemoto
- Japanese/pub Ton Ton
- French ghi la Vache
- Soba Soba Ichi

**Basement Level**

- Japanese/pub Meki-no Ginji
- Ramen Aoba
- Bar UNTITLED

**KEY**

- Restaurants (Open Lunch & Dinner)
- Restaurants (Open Lunch & tea time)
- Restaurants (Open Diner)
- Pedestrian way
- Super market
- ATM
- Rent-a-bicycle (ca)



# SHOPPING

## Shop Guide around Tsukuba Station

Information updated August 8, 2022.  
Please note that any changes after that are not reflected.



**Information**..... BIV1F  
 Tourist Office · Rental Cycles  
 Bus Ticket Office

Local Souvenir Shops	Made In Tsukuba..... A
	Tsukuba-shi Bussankan..... A
	Museum Shop 「a」..... B
	Keisei Department Store (Tsukuba shop)..... Q' 12F
	Plechef..... Q' 11F
	Tsukuba sweets..... Q' 11F
	Kantetsu Create (Tsukuba shop)..... BIV1F
	La Cote d'Azure..... C
	Libro..... Q' 12F
	Matsumoto Kiyoshi..... Q' 11F
Book Store	Matsumoto Kiyoshi - York Town 1F
	Sun Drug..... DAYZ TOWN 1F
	Welcia..... D
Drug Stores	Illusie 300 (300 Yen shop)..... Q' 11F
	Daiso..... York Town 1F
	Daiso..... CRED 3F
100 Yen Shops	Loft..... Q' 13F
	Q't..... Q' 1 1F / 2F / 3F
Fashionery	GAP/GAP Kids, ABC-MART, adidas, Brand Core Store, Ladies Fashion, Fashion Goods
	Active Outdoor Town..... Q' 1 3F
Clothing	Columbia Sportswear, Mountain Hardware, mont-bell, Ogawa Grand Lodge, LOGOS-Shop
	Q't..... Q' 1 1F / 2F / 3F
Outdoor	Decohome..... CRED 3F
	Eye City (contact lenses)..... Q' 11F
Goods	Jins (glasses)..... Q' 13F
	K's Denki..... CRED 2F
Glasses/Contact Lenses	York Benimaru..... York Town 1F
	Seiyu..... DAYZ TOWN 1F
Electronic Store	Lopia..... CRED 1F
	Plechef (specialty food store)..... Q' 11F
Supermarkets	Wakuwaku Hiroba (vegetables)..... CRED 1F
Grocery Stores	

Hospital	Tsukuba Ogawa Clinic..... MOG1F	Tsukuba Cityia Building..... ①
	Cute Dental Clinic..... MOG1F	Ophthalmology/Internal Medicine/Geriatrics/Dermatology/Orthopedics
	Earth Dental Clinic Tsukuba..... BIV14F	Tsukuba Center Clinic (Internal Medicine)..... ②
	Eagle Osteopathic Clinic..... York Town 1F	Tsujinaka Tsukuba Clinic (Gastroenterology)..... ③
	Akizuki Dental Clinic..... York Town 1F	Stress Care Tsukuba Clinic..... ④
		Takezono Central Dental Clinic (Psychosomatic Medicine)..... ⑤
		Nomura E.N.T. Clinic (Otorhinolaryngology)..... ⑥

# EXCURSION RECOMMENDATIONS

On Tuesday (day 2), there will be an opportunity for S4SN Japan Meeting attendees to explore Japan. You can find excursion proposals, suggested by the Local Committee.

- If you plan on joining the excursions, please remember to bring cash. This can be in JPY or a Suica card, mostly to pay for busses and trains.
- There will be a Help Desk near where you will register for the Meeting, to answer any questions (e.g., train and bus schedules) about things to do during excursion time.
- There will also be a sign-up sheet on Monday (day 1), so that you can travel together and explore Japan in groups.
- You can find a summary of excursion recommendations in this travel booklet. We have also created a website with more detailed description of suggested visits - take a look!



# EXPLORING TSUKUBA AREA

## Plan 1: Mount Tsukuba for hiking and more (Sake-Tasting).

Mount Tsukuba is one of the famous mountains in Japan. There are multiple plans to enjoy the Mount Tsukuba area.



- Take the local bus line to the Tsukuba Shrine (Tsukubasan jinja iruguchi). You can find the bus routes [here](#).
- Once at the Tskuba Shrine, take the cable car/ropeway to the peak. You can find more about [tickets here](#). Please note that there is a 5-minute steep uphill walk to the cable station. You can find more about the Tsukuba Shrine from this [link](#).
- For those who are more adventurous, there are multiple hiking routes that you can enjoy. You can find more from this [link](#).
- Once at the top of Mount Tsukuba, enjoy the cherry blossoms!
- You can also visit a [sake brewery](#) and a hot spring ([Tsukuba no yu](#)).



# EXPLORING TSUKUBA AREA

## Plan 2: National Institute in Tsukuba City for more science!

Mount Tsukuba is one of the famous mountains in Japan. There are multiple plans to enjoy the Mount Tsukuba area.



- Visit the botanical garden (opening hours: 09:00-16:30, last entry at 16:00). You can take the local bus, walk or rent a bike.
- Visit the Tsukuba EXPO Center, a science museum (opening hours: 09:50-17:00, last entry at 16:30). You can find more information here.
- Visit the Tsukuba Space Center, JAXA (opening hours: 10:00-17:00, free admission). You can find more information here.
- Visit the Tsukuba Geological Museum (opening hours: 09:30-16:30, free admission). You can find more information here.
- See the cherry blossom around National Agriculture Research Organization (NARO) (opening hours: 09:00-16:00, free admission).

# EXPLORING TSUKUBA AREA

## Plan 3: Cycling around Kasumigaura Lake or Mount Tsukuba

For those who prefer outdoor activities, you can cycle around Tsukuba area and explore all that Tsukuba has to offer.



- Take the local bus to Tsuchiura, and rent a bike. You can find more about various cycling routes from [here](#). You need to book the bikes in advance.
- You can also go strawberry picking, or go on a boat ride in Kasumigaura.

# EXPLORING TOKYO AREA

## Plan 4: Asakusa and Akihabara area

Visit Asakusa is known for its famous temple (Senso-ji) and Skytree Tower. Akihabara is a town filled with electronic gadgets, pop-culture, and cooking utilities!



- Take the TX to Asakusa Station (40-50 minutes), then a metro. You can return to Tsukuba via Akihabara on the TX.
- You can find more about Asakusa from [here](#).
- [Kappabashi](#) is a town famous for cooking utilities.
- You can go up [Skytree Tower](#) to get a panoramic view of Tokyo.
- You can enjoy cherry blossoms from [Sumida River](#). You can find more cruise options from [here](#).
- [Akihabara](#) is a town of electronics and Japanese pop culture.

# EXPLORING TOKYO AREA

## Plan 5: Imperial Palace area, Tokyo Station, and Ginza

This suggested plan gives you an opportunity to enjoy traditional and modern Japan!



- Take the TX and metro to the centre of Tokyo. You can either take the TX back or take the highway bus from Tokyo Station.
- You can enjoy cherry blossoms from many locations in Tokyo, but some famous places includes Kitanomaru Park, and Chidorigafuchi.
- You can also visit the Imperial Palace and nearby areas, such as the Imperial Palace Each Garden, and Nijubashi Bridge.
- The Imperial Palace is close to the Marunouchi and Tokyo Station area, as well as the Ginza district.



# EXPLORING TOKYO AREA

## Plan 6: Ueno area

Ueno area is home to many museums and cultural experiences.



- Take the TX and JR line or metro to Ueno Station.
- You can enjoy cherry blossoms in Ueno Park.
- For attendees with young children, Ueno Zoo (opening hours: 09:30-17:00, last entry at 16:00) is also in the area.
- There are many museums in Ueno. You can enjoy National Museum of Nature and Science, Tokyo National Museum, and National Museum of Western Art.
  - Tokyo National Museum currently has a special exhibition of Golden Hall of Chusonji Temple.
- Near the Ueno area, you can also venture out to Ameyoko Street, which is a market street full of Japanese culture.

# EXPLORING TOKYO AREA

## Plan 7: Tsukiji and Shiba area

Go to Tsukiji and Shiba for some sushi, Japanese goods, Japanese style garden, temples, and more!



- Take the TX and JR line or metro to a nearby station.
- Visit Tsukiji, a former fish market. The current one has moved to Toyosu.
- You can also enjoy cherry blossoms at Hamarikyu Garden, or from Shiba Zojoji Temple.
- You can enjoy a panoramic view of Tokyo from Tokyo Tower.

# EXPLORING TOKYO AREA

## **Plan 8: Shibuya and Shinjuku**

Shibuya is famous for its scramble crossing, and these areas are full of new buildings, parks and more!



- Take the TX and JR line or metro to Shibuya, Harajuku, or Shinjuku Station.
- Explore Shibuya area, and its big scramble crossing.
  - If you want a nice view of the scramble crossing, go to the second floor of Starbucks in front of the crossing.
- You can enjoy Harajuku and Omotesando area, and Meiji Shrine which is nearby.
  - Takeshita Street is known for its fashion. If you go to small streets off of it, there are lots of vintage shops.
- You can enjoy cherry blossoms in Yoyogi Park, and Shinjuku Gyoen Park.



# EXPLORING TOKYO AREA

## Plan 9: Cherry blossom in Japanese style gardens

If you want to enjoy cherry blossoms in Japanese style gardens, there are many options available!



- Take TX and JR line or metro to the nearby stations. You can visit one of these gardens as part of other excursion plans.
  - Koishikawa korakuen garden
  - Rikugien garden
  - Mukojima hyakkaen garden
  - And many more! Please see the website for more ideas.

# MORE EXPLORING

Excursion plans recommended by the local committee are in no way an exhaustive list of places to see in Tsukuba and Tokyo. You can find more suggested places to visit below, and on the [website](#). You can also ask the local committee at the Help Desk.



- For a quick overview of Tsukuba, please click [here](#).
- For some shopping and art, you can go to [Tokyo Midtown](#), and [Azabudai Hills](#).
- [Odaiba](#) via Sumida River boat
  - You can find a life-size" Gundam statue at DiverCity Tokyo Plaza.
- [teamLab](#) has multiple immersive art exhibits (that is all over Instagram!)
  - One of the exhibits is in Azabudai Hills (mentioned above).
- Other Japanese experiences include going to hot springs, karaoke, convenience stores, and more.

Some useful websites to look for things to do in Japan are:

- [Travel Japan](#)
- [Japan Guide](#)

S4SN planning and local committees have worked to make this conference a special one, including enjoying all that Japan has to offer, during the special cherry blossom season. We hope that you have a wonderful time!

If you have any questions, please stop by the Help Desk. We are more than happy to answer any questions and give you suggestions.

